



Thank you for purchasing our product. Before installing/operating the product, read the instructions carefully and retain them for future reference.

## ⚠ Attention!

- For installation, follow the steps described below. Any damage caused by wrong installation shall be imputed to the users.
- Do not disassemble or change any parts. Opening and disassembling this unit will void any warranty.
- Maintenance and repairs should be executed by our professionals only.

### NOTE

⚠ Some procedures must be followed to avoid damages to the product.

⚠ **WARNING!** Certain procedures must be followed to avoid damages to yourself, to the vehicle or to others.

🔧 Denotes the tightening torque value.

## 1 Accessories

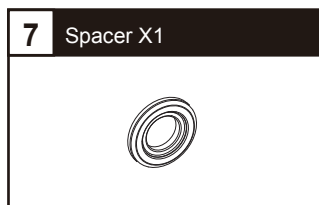
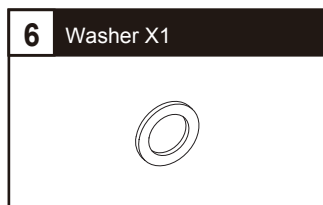
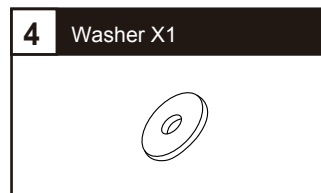
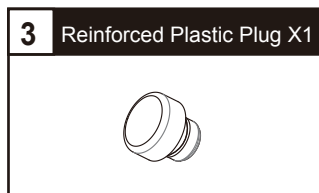
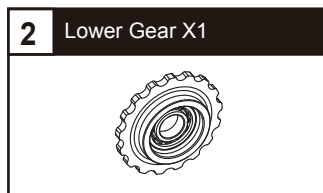

## 2 INSTALLATION INSTRUCTIONS

### Proceed as follows

- 1 STD M8xP1.25xL25 Screw X1
- 2 STD Washer X1
- 3 STD Shaft X1
- 4 Reinforced Chain tensioner (Accessory 1)
- 5 Screw X1 (Accessory 5)
- 6 Washer (Accessory 6)
- 7 Lower Gear (Accessory 2)
- 8 Spacer X1 (Accessory 7)
- 9 STD M14xP1.5xL8.5 Screw X1
- 10 Reinforced Plastic Plug (Accessory 3)
- 11 Washer X1 (Accessory 4)  
(only apply if the chain tensioner is too tight after fasten.)

**NOTE** Install the Spacer according to the direction shown in the diagram, and ensure the Spacer covers the bolt.

