



● Thank you for Reinforced Chain tensioner KOSO · Before installation, please read the instruction carefully. We recommend that you store the instruction sheet in a safe place for future reference.

**▲ NOTICE**

- To install, follow the steps as described in the manual. Any damages caused by not following directions voids warranty.
- Correct tools must be used for installation.
- Do not modify any parts unless specifically stated in the instruction manual.
- Interior control maintenance should be performed by a professional only.

**MARK MEANING:**

▲ Some procedures must be followed to avoid damages to the instrument.

**▲WARNING!** Some procedures must be followed to avoid injuries to the user or others.

**▲CAUTION!** Some procedures must be followed to avoid damages to the vehicle.

Denotes the tightening torque value.

**1 ACCESSORY**

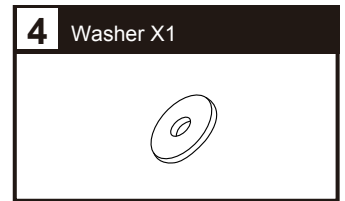
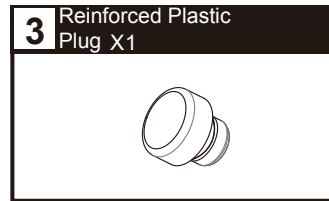
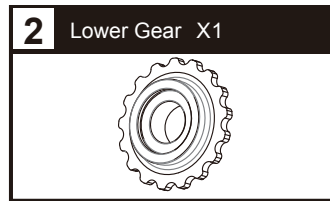
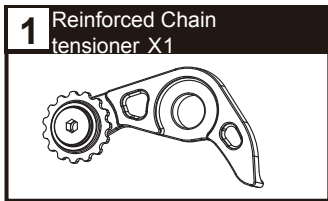

**NOTE** Please contact your local distributor if the items received are not the same as the one listed above.

**2 INSTALLATION INSTRUCTIONS**

**Please proceed as follows**

- ① STD M8 X P1.25 X L25 Screw X1
- ② STD Washer X1
- ③ STD Shaft X1
- ④ Reinforced Chain tensioner (Accessory 1)
- ⑤ STD M6 X P1.0 X L16 Screw X1
- ⑥ Lower Gear (Accessory 2)
- ⑦ STD M14 X P1.5 X L8.5 Screw X1
- ⑧ Reinforced Plastic Plug (Accessory 3)
- ⑨ Washer X1 (Accessory 4) (only apply if the chain tensioner is too tight after fasten.)

